



ATLANTA

MIDTOWN

WHERE MIDTOWN IS IN THE MIDDLE OF IT ALL.

WHO W Atlanta - Midtown and you.

**WHAT** Creative in approach and innovative in design, W Hotels will engage and energize your meeting attendees. Our unique Sensory Set Up<sup>®</sup> gets ideas flowing with mood music, signature scents and more. Get out of that mid-day rut to uncover hidden talents and learn new skills with Wish Workshops<sup>SM</sup>, where you can do anything from learning to be a chef to yoga lessons. And if work isn't working for you, take a break with Recess<sup>SM</sup>. Delight in a menu of activities that's fun and beneficial to everyone. Perfect for work and play, when W Hotels takes care of business, you'll love the results.

433 Guestrooms, 29 Suites, 3 WOW Suites and 1 Extreme WOW Suite

**WHERE** For more information contact our sales office.

T 404 733 6968 F 404 876 3276

AN EXCLUSIVE WHATEVER/WHENEVER<sup>®</sup> EXPERIENCE

STARWOOD PREFERRED GUEST 1 877 WHOTELS EXPLORE WHOTELS.COM BEST RATES. GUARANTEED.

### LIVING ROOM LEVEL

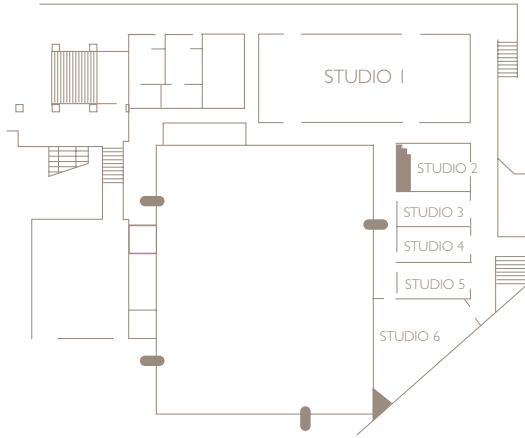

### TOP FLOOR



### LOWER LEVEL

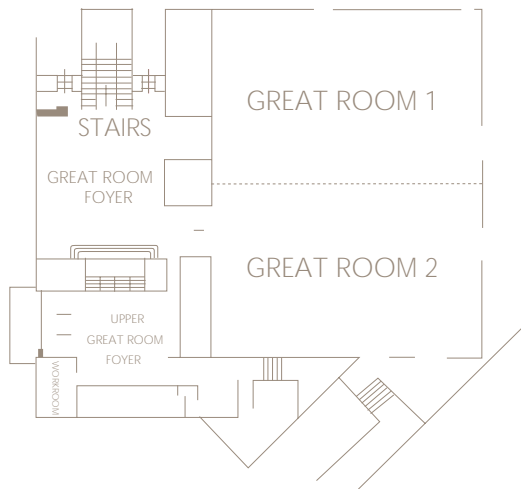

### MEZZANINE LEVEL

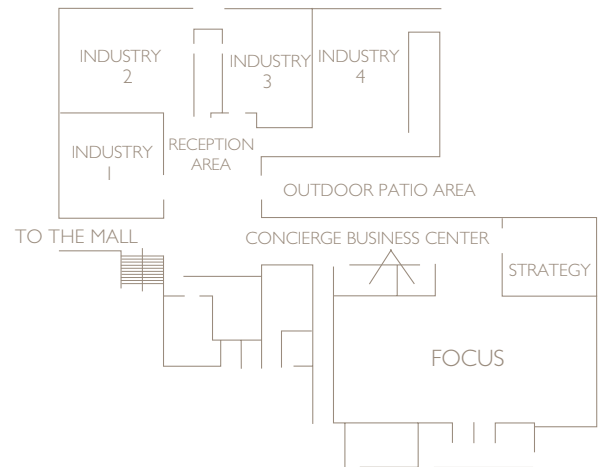

Room	Dimensions	Ceiling Ht.	Sq. Ft.	Theatre Style	Classroom	Conference	Reception	Banquet
Great Room	109' X 86'	17' 10"	9,555	1,500	720	-	1,500	800
Great Room 1	54' X 86'	17' 10"	4,777	750	325	-	750	400
Great Room 2	54' X 86'	17' 10"	4,644	750	325	-	750	400
Studio 1	87' X 35'	12' 1"	3,054	300	150	75	325	240
Studio 2	22' X 20'	12'	524	50	25	25	50	30
Studio 3	30' X 14'	12'	449	45	25	25	50	30
Studio 4	30' X 14'	12'	452	45	25	25	50	30
Studio 5	29' X 16'	12'	430	45	25	25	50	30
Studio 6	36' X 44'	11'	1,085	100	65	25	110	90
Altitude	71' X 54'	12'	3,784	200	150	75	300	260
Industry 1	30' X 30'	12'	870	56	30	24	75	40
Industry 2	37' X 31'	12'	1,206	76	56	40	100	70
Industry 3	34' X 27'	12'	906	56	30	24	75	50
Industry 4	41' X 27'	12'	1,172	76	38	32	100	60
Strategy	27' X 21'	12'	547	40	18	22	50	30
Focus	76' X 34'	12'	2,590	175	120	76	250	180
Workroom	12' X 18'	12'1"	209	-	-	10	-	10